

State of Mississippi
 Department of Archives and History
 P.O. Box 571
 Jackson, MS 39205

HISTORIC RESOURCES INVENTORY

1.a. Property Name, Historic		14. MDAH Inventory Code
1.b. Property Name, Common		15. County Lafayette
2. Property Address 1618 University Avenue		16. City Oxford
3. Legal Description 97A:50		20. USGS Quad Map
19. Ownership private	22. Condition fair	21. UTM Reference
4. Former/Historic Uses residence	5. Present Use office	24. Principal Materials frame
3 & 7. Significant persons, events, themes, including dates of association		
3. Date of Construction ca. 1935	9. Historic Changes	23. Post Historic Changes
10. Architect	11. Builder/Contractor	25. Architectural Style Craftsman

13. Outbuildings or Secondary Features (use sep. form if important)

12. Brief Description: One-story, three-bay, frame double-pile cottage with Craftsman influence, built ca. 1935. Cross gable roof covered with asphalt shingles, with exposed rafter tails. Exterior walls covered with asbestos siding. Windows are 6/6 double-hung sashes. Entrance covered with shed roof hood supported by simple braces and contains a single-light replacement door.

30. Historical Information: This structure does not appear in any of the Sanborn map series.

31. Historical Contexts:

33. Sources of Information:

32. Additional Remarks or Information:

35. Owner's Name and Address

36. Photographer/Source
John Hopkins

37. Photo Roll/Frame
3575:9

38. Photo Date
January, 2000

39. Form by Hopkins & Associates, Memphis, TN

40. Survey Project Oxford

Date of Form January, 2000

Attach Photograph



MDAH INFORMATION

26. Category

27. Functional Type

28. Registration Status/Dates
 NHL
 Listed NR
 In NR District
 Federal DOE
 State Landmark
 Local Landmark
 In Local District
 HABS/HAER

29. District Name

Rating C/N C
 Inventory #

42. Other HPD Information

43. Evaluation

a. Already Listed NR
 Individually Eligible
 Eligible if Restored
 Contribute to District
 Apparently Not Eligible
 Insufficient Information
 Not Extant

b. Area(s) of Significance

c. Evaluated by/date

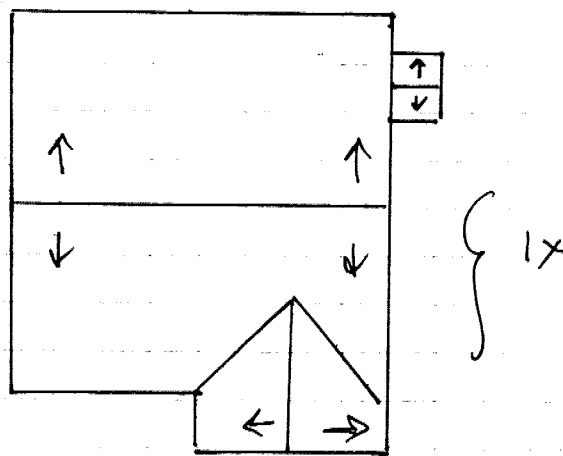

↓ N